

Residential off-grid (AC coupled)

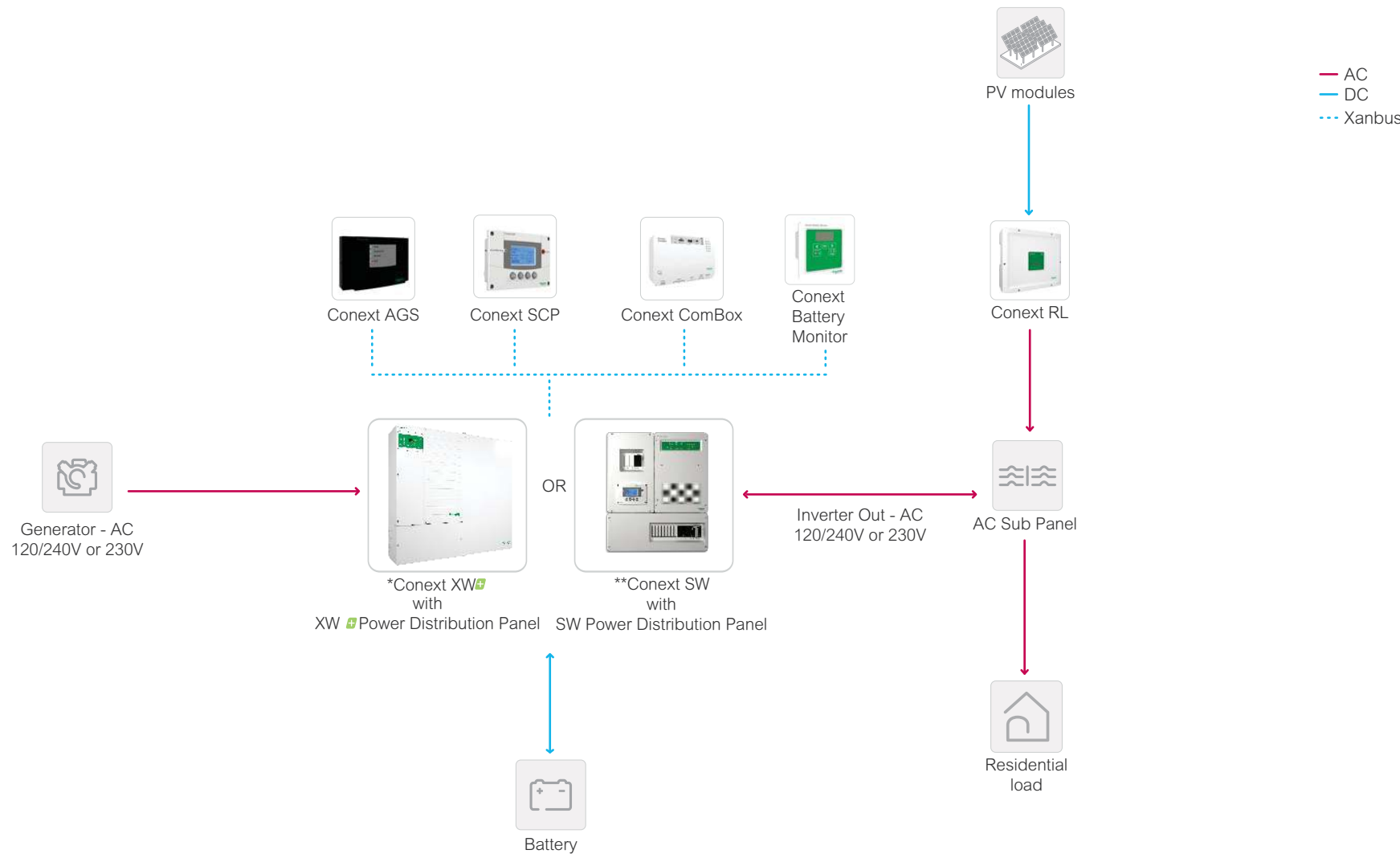

XW+ Single-phase or split-phase (120/240VAC or 230 VAC) solution with optional AGS/Generator (7.0 kW – 25.5 kW)
 *Up to two slave units are optional to increase power
 SW Single-phase or split-phase (120/240VAC or 230 VAC) solution with optional AGS/Generator (2.5 kW – 8.0 kW)
 **Additional unit is optional to increase power
 Note: Confirm AC coupling compatibility with PV inverter manufacturer prior to installation