

Residential, self consumption

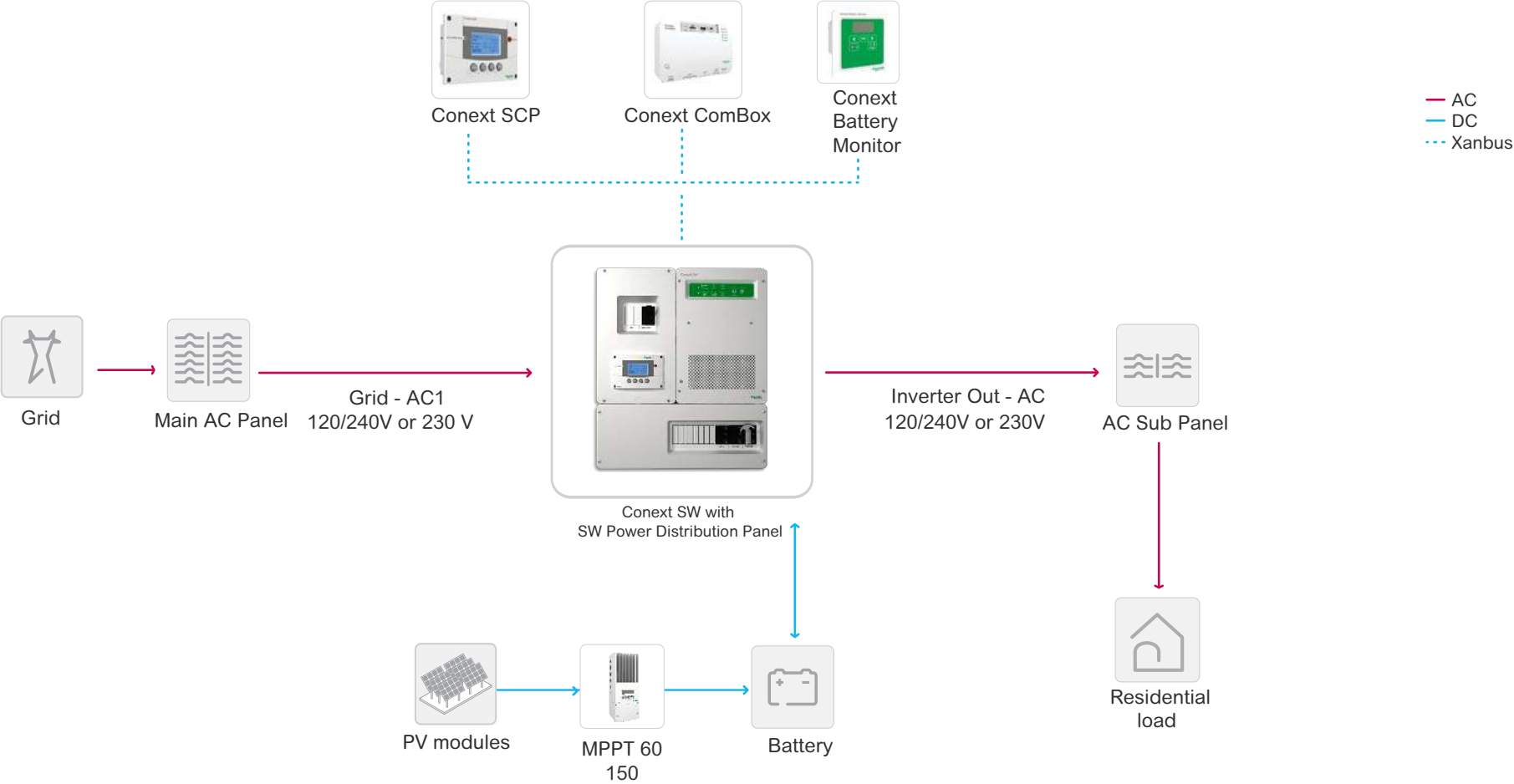

Single-phase or split-phase (120/240VAC or 230 VAC) solution (2.5kW – 8.0kW)
 Additional slave unit is optional to increase power
 Parallel Power: With Grid Support enabled, battery power is converted to AC Power supplementing the grid input to help avoid peak utility charges – Load Shaving.
 Priority Power: The consumption of solar power or battery power is prioritized before purchasing power from the utility.